

SABEREDGE™

Optimized performance meets reliability and durability.

REDUCED OPERATIONAL COST THROUGH MAINTENANCE REDUCTION

- *Reduced lip repair through increased adapter stabilization*
- *Increased production through quick hardware change out*
- *Standard mechanical wear protection - Saberlock™*
- *Optimized lip shrouds resulting in less throwaway material*



SQUARE CORNER

- Komatsu 2800 - 4100XPC
- CAT BE495 & 7495

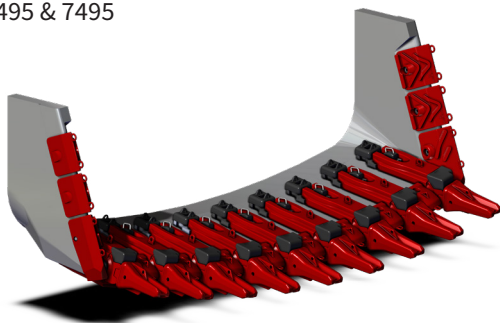

WIDE RADIUS

- Komatsu 2800XPC Optima
- Komatsu 4100XPC Optima

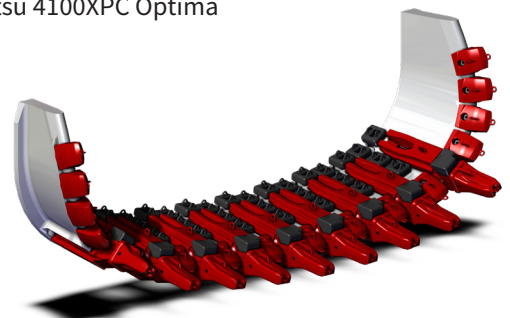

EFFICIENT AND VERSATILE

Universal G.E.T.

Simplify your stock orders and logistics with a suite of universal G.E.T. and mechanical locking systems. The Saberedge™ G.E.T. fits both square corner and wide radius rope shovel lips to enhance your dig experience.

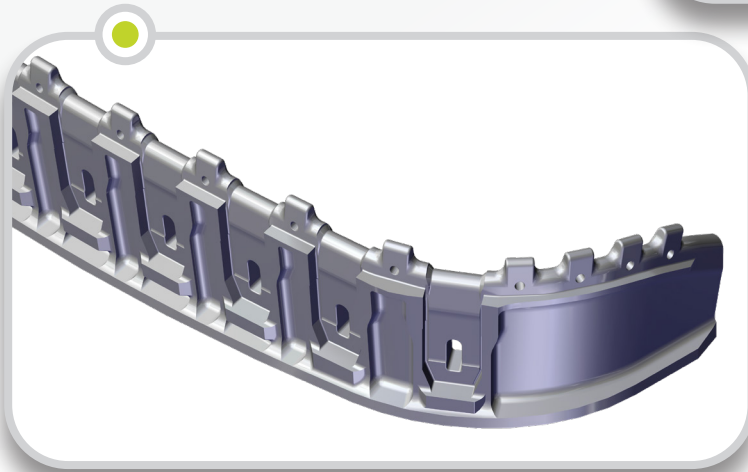
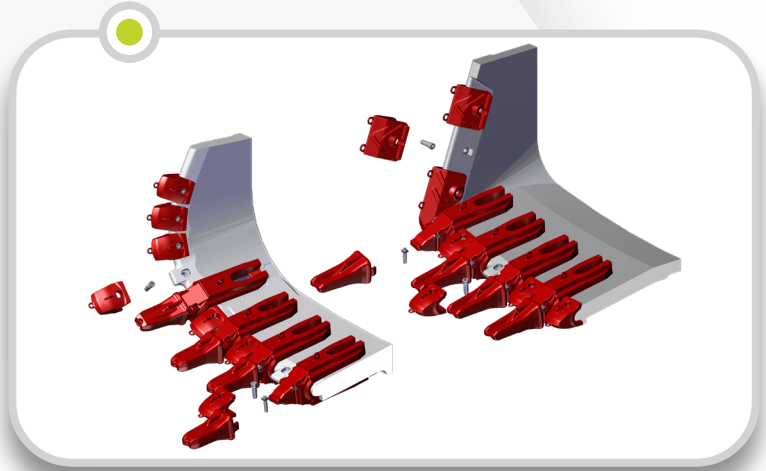

Reduced Maintenance

The Saberedge™ lip offers increased adapter stabilization on both sides of the lip. Stabilizing the adapter onto the lip reduces lip wear and lip maintenance. Resulting in shorter downtimes with increased production.

Mechanical Wear Pad System

Eliminate Hot-work and decrease risk and downtime with our fully mechanical wear pads. The Saberlock™ system offers a fully customizable application, providing total lip protection for any bucket. The Saberlock™ system can also be utilized for entire bucket liner packages.

